

# FIRE DOOR 15

## LVH44 AIR TRANSFER GRILLE FITTED INTO STEEL FRAME WITH TAB PLATE FIXINGS

DESCRIPTION	
1	Steel frame as part of associated doorset framing system
2	Lorient intumescent sealant around air transfer grille perimeter to a maximum clearance of 10mm
3	Lorient LVH44 intumescent air transfer grille
4	4mm intumescent liner
5	<b>Fixing tab:</b> 40 x 20 x 1mm thick minimum galvanised steel tabs fixed to LVH44 unit with self tapping screws and to steel frame with self tapping screws
<b>Fixing option 1:</b> 20mm wide tabs, central to all four sides or at 200mm maximum centres	
<b>Fixing option 2:</b> Full width tabs top and bottom only with 200mm fixing centres	

CONTENTS	TOOLS REQUIRED
<ul style="list-style-type: none"> <li>• LVH44 air transfer grille</li> <li>• 4mm graphite liner</li> <li>• Cover grille (optional)</li> </ul>	<ul style="list-style-type: none"> <li>• Tab plate fixings</li> <li>• Self tapping screws (3.5 x 16mm)</li> <li>• Lorient intumescent sealant</li> </ul>

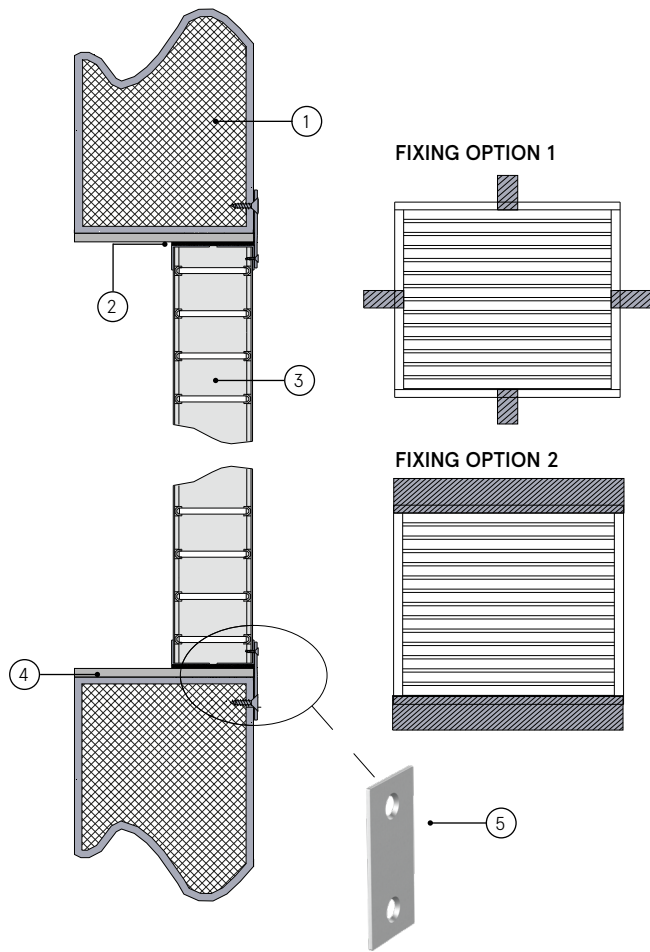

### LVH44 for steel frame with tab plate fixings

#### FD120

**Fire Resistance in accordance with**  
BS 476-22:1987

**Approval Ref**  
WFRC C121316 (AW4S2)

**Max single cell size**  
Any rectangular shape up to 1200 x 600mm

LVH44 air transfer grilles are supplied 2mm less than the nominal size e.g. a 300mm x 300mm is actually 298mm x 298mm.

### INSTALLATION INSTRUCTIONS

- ▶ Apply Lorient intumescent liner to the inside faces of the aperture.
- ▶ Fix the mounting tabs onto the LVH44 air transfer grille using self tapping screws to **one side only**.
- ▶ Insert LVH44 into steel frame. (Note: air transfer grille does not have to be centrally positioned in the opening).
- ▶ Fix the tabs to the steel frame with self tapping screws.
- ▶ Apply a bead of Lorient intumescent sealant around the perimeter of LVH44 as shown (note: maximum clearance of 10mm applies).
- ▶ **Note: Fixings supplied by others.**