



WALL 11

LVH44 FITTED INTO RIGID WALL CONSTRUCTION

WALL MOUNTED SYSTEMS

DESCRIPTION

- 1 Rigid wall construction
- 2 Mortar facing over irregular surface
- 3 Aluminium cover grille
- 4 LVH44 air transfer grille
- 5 Air transfer grille fixing screws into wall plugs
- 6 Use Lorient intumescent sealant to bed air transfer grille into the wall
- 7 Cover grille fixing screws into wall plugs.

CONTENTS

- LVH44 air transfer grille
- Aluminium cover grille (optional)

TOOLS REQUIRED

- 50mm screws
- Wall plugs for 50mm screws
- Lorient intumescent sealant

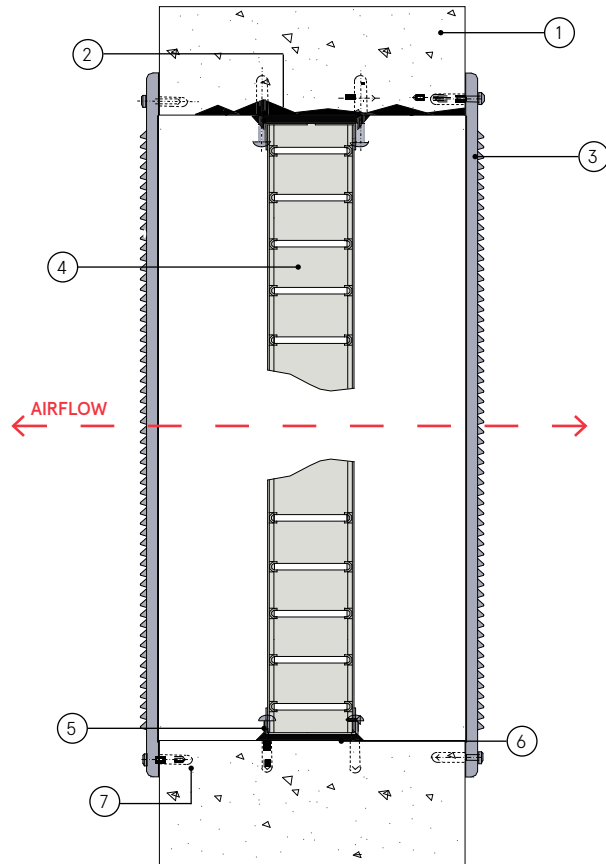

Note: To achieve insulating rating, an aluminium cover grille must be fitted.

LVH44 fitted into rigid walls

EI90*/EI120**

Fire Resistance in accordance with

BS EN 1364-5:2017

Approval Ref

19/19894-253

Max single cell size

*1000mm (w) x 500mm (h)

** 600mm x 600mm

LVH44 air transfer grilles are supplied 2mm less than the nominal size e.g. a 300mm x 300mm is actually 298mm x 298mm.

INSTALLATION INSTRUCTIONS

- ▶ Cut the aperture to the required size with a maximum gap all around of 5mm. If resulting aperture is out of square, irregular or oversized, make good with mortar.
- ▶ Trial fit the LVH44 into the aperture and ensure that it can be positioned within the section of the wall but not necessarily in the mid position, without jamming or twisting.
- ▶ Mark the position of drill points into wall either side of the LVH44.
- ▶ Remove the LVH44 from the wall aperture.
- ▶ Fix screws into wall with a minimum of 4 screws around the perimeter. For larger units use a maximum of 200mm between centres to provide up to 8 screws per side.
- ▶ Position LVH44 and repeat installation of screws on closest side of the LVH44.
- ▶ Bed in sealant around LVH44. Clean off surplus and ensure outer edge of the air transfer grille is fully sealed.
- ▶ Position aluminium cover grille centrally over one face of the LVH44 and fix using wall plugs supplied.
- ▶ Repeat to other face if two cover grilles are to be fitted.
- ▶ **Note: Fixings supplied by others.**