

FLOOR 5

MASONRY FLOOR USING PRE-CAST SLAB TO SUIT

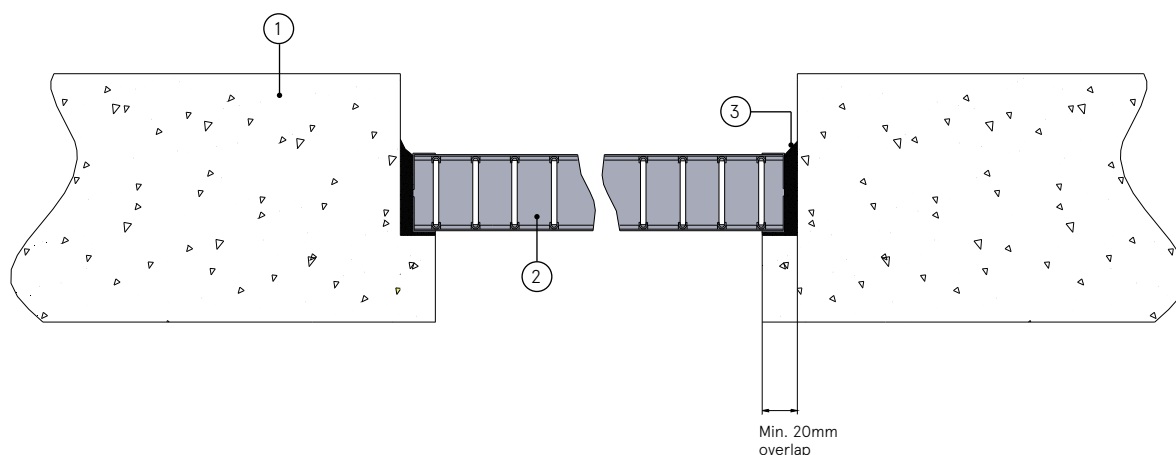

DESCRIPTION

- 1 Pre-cast concrete slab
- 2 LVH44 air transfer grille
- 3 Lorient intumescent sealant around LVH44 perimeter to a maximum clearance of 10mm

CONTENTS

- LVH44 air transfer grille

TOOLS REQUIRED

- Lorient intumescent sealant



Note: If no reticulating ductwork is above the slab a protective and load-bearing grate is necessary.

Masonry floor using pre-cast slabs to suit FR120

Fire Resistance in accordance with

BS 476-22:1987

Approval Ref

WFRC C121316 (AF3)

Max single cell size

600 x 600mm

Larger sizes can be used with different mounting detail.

LVH44 air transfer grilles are supplied 2mm less than the nominal size e.g. a 300mm x 300mm is actually 298mm x 298mm.

INSTALLATION INSTRUCTIONS

- ▶ Prepare slab with cast in ledges (minimum 20mm overlap of ledge with LVH44).
- ▶ Mount LVH44 onto masonry floor opening.
- ▶ Apply a bead of Lorient intumescent sealant around the perimeter of air transfer grille between the LVH44 and the floor (note: maximum clearance of 10mm applies).
- ▶ Connect ductwork (or cover grille) directly to floor using approved breakaway connections to ensure compliance.